

 **EUROBOOR**  
FOR PROFESSIONALS BY PROFESSIONALS



**BURRS AND  
MACHINES**



# DIE GRINDING MACHINES

Exceptionally powerful for demanding use

- Maximum Control & Power
- Ergonomic
- VibraTec for perfect balance

At Euroboor we develop all of our machines with the professional users in mind. By using high quality materials, our grinding machines deliver excellent results. Euroboor die grinders are the number one choice for grinding, polishing, deburring and smoothening sharp edges. They are specially engineered to give you maximum control and the power you need to get the job done fast and safely.

Euroboor offers you both Electric and Air Pressured grinding machines which brings you great results under all circumstances. We continuously improve our machines by making them lighter, more ergonomic and by reducing vibration. The Euroboor VibraTec technology makes sure that vibration is minimized, which contributes to smoother, high quality finishes!

We invite you to take a closer look at our product range and see what we can do for you.

## **VibraTec** Technology

Vibration limitation for easy operation, perfect balance and high quality finishes!

Other brand



Euroboor



Please refer to our VibraTec technology grinding machines to see what they could offer you!



# CARBIDE ROTARY BURRS

The best choice for you!



Why choose Euroboor carbide rotary burrs?  
**Simple: They are tough to break and provide high stock removal!**



## **Samurai precision!**

Advanced heat treatment technology is applied on Euroboor rotary burrs, improving the strength of the steel, creating sharper edges and wear resistance.



## **HIGH stock removal & save time!**

Thanks to the design and characteristics of tungsten carbide, Euroboor rotary burrs provide high stock removal. This saves a lot of time and energy.



## **Silver welding**

The improved welding technology on the shank makes the burrs very strong and capable of handling high forces and high temperatures without breaking.



## **Lasts 50% longer!**

Due to the innovative surface treatment and choice of materials, the Euroboor rotary burrs last 50% longer compared to conventional rotary burrs.



## **Conical shaped shank**

The advanced conical shape of the shank divides the pressure over a larger area, making the burr less likely to break under high forces.



## **High durability – Less waste**

All of our research, innovations and applied technologies bring you high quality rotary burrs that are suited for the toughest jobs, without breaking or losing performance. This means no more waste of burrs and money. That makes Euroboor burrs the best choice for you!

# ROTARY BURRS

## OVERVIEW

Euroboor carbide rotary burrs are available in different cuts, models and sizes. Your choice depends on which material you have to work on and what finish you need.

Our burrs have a universal shank, but are best used combined with one of the Euroboor grinding machines.





## DIAMOND CUT ROTARY BURRS

**13  
TYPES**

Create smooth finishes

### Use with:

Euroboor die grinders  
ADG.2A, ADG.2S,  
ADG.2E, EDG.600  
EBG.600/18V  
or other powerful  
die grinders

### Applications:

- Cutting out holes
- Deburring
- Leveling
- Milling out
- Surfacing
- Smoothing welds
- Shaping

### Also suitable for:

- Robot
- Flexible and  
straight shaft drive
- CNC machines



**10  
TYPES**

Use on  
non-ferrous  
materials

## ALU CUT ROTARY BURRS

# CARBIDE BURRS & APPLICATIONS

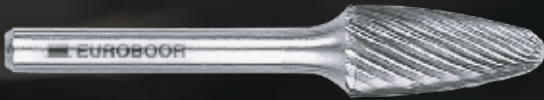

## Single cut carbide burr

Single cut provides superior stock removal with long chips, and good surface finishes.

### Ideal for

Cast iron

Cast steel

Unhardened steels

Low alloy steels

Stainless steel

Brass

Bronze / Copper



## Double cut carbide burr

Double cut burrs allow fast stock removal. The finer tooththing surface provides high stock removal with fine and short chips for high control and great surface finish.

### Ideal for

Cast iron

Cast steel

Unhardened steels

Low alloy steels

Stainless steel

Brass

Bronze / Copper

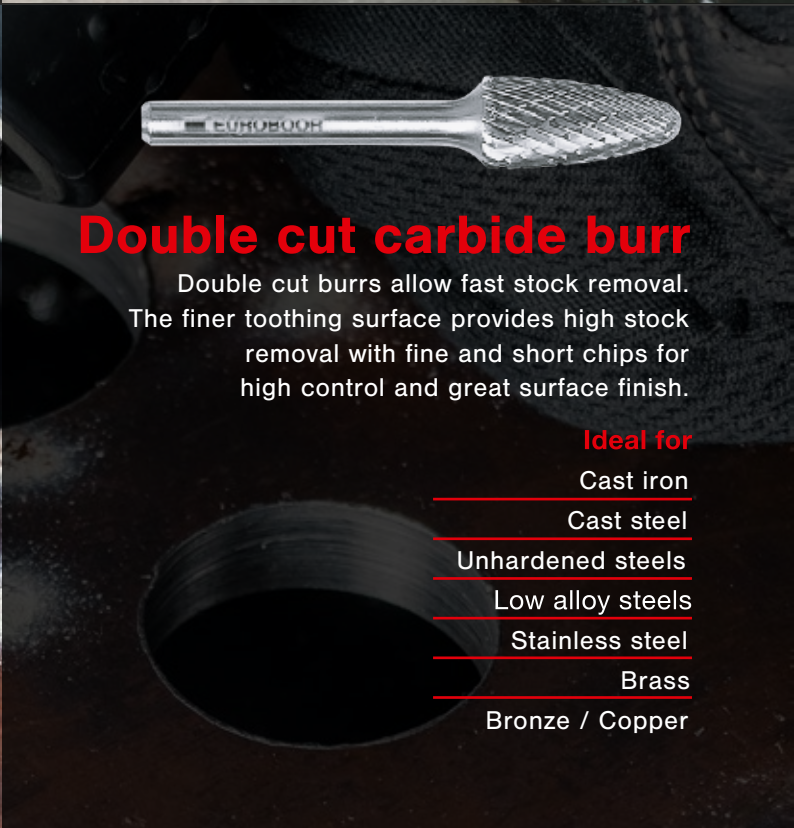

Our carbide burrs can be used on most hard materials, such as hardened and unhardened steel, aluminium and cast iron. The Euroboor carbide burrs are perfect for professionals as they will last

for a long time, under high loads or high temperatures, without breaking or chipping. Different cuts of carbide burrs are available with each cut having its own characteristics and capabilities.



## Diamond cut carbide burr

This uniquely developed burr shape enhances the capacity of control and smooth processing on harder steel types. The extra fine tothing creates the best surface finish with extremely small chips, and high stock removal.

### Ideal for

Cast iron

Cast steel

Unhardened steels

Hardened steels

Low alloy steels

High alloy steels

Heat treated steels

Stainless steel

Titanium alloy

Brass

Bronze / Copper



## Alu cut carbide burr

They are especially designed to have a high stock removal on non-ferrous materials.

### Ideal for

Plastics

Aluminium

Zinc alloy



# CARBIDE ROTARY BURRS SPECIFICATIONS



Our carbide rotary burrs are available in different cuts, models and sizes. All with their own characteristics and capabilities. Due to our innovative shape and welding technique, the burrs have high durability. Due to advanced heat treatments, the

carbide rotary burrs are long lasting and capable of high stock removal with fine grains. This makes the Euroboor carbide burrs perfectly suitable for all kind of situations.

	Cast iron	Cast steel	Unhardened steels	Hardened steels	Low alloy steels	High alloy steels	Heat treated steels	Stainless steel	Titanium alloy	Brass	Bronze / Copper	Plastics	Aluminium	Zinc alloy
Single cut	•	•	•		•			•		•	•			
Double cut	•	•	•		•			•		•	•			
Diamond cut	•	•	•	•	•	•	•	•	•	•	•			
Alu cut												•	•	•

## Type A

Without end cut

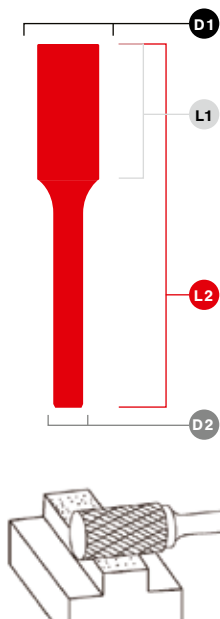

### Single cut

D1	D2	L1	L2	Code
3	3	13	38	RBS.A0303
6	6	16	61	RBS.A0606
8	6	20	65	RBS.A0806
10	6	20	65	RBS.A1006
12	6	25	70	RBS.A1206
16	6	25	70	RBS.A1606

### Double cut

D1	D2	L1	L2	Code
3	3	13	38	RB.A0303
6	6	16	61	RB.A0606
8	6	20	65	RB.A0806
10	6	20	65	RB.A1006
10	6	20	170	RBDL.A1006
12	6	25	70	RB.A1206
12	6	25	175	RBDL.A1206
16	6	25	70	RB.A1606

### Diamond cut

D1	D2	L1	L2	Code
8	6	20	65	RBD.A0806
10	6	20	65	RBD.A1006
12	6	25	70	RBD.A1206
16	6	25	70	RBD.A1606

### Alu cut

D1	D2	L1	L2	Code
6	6	16	61	RBA.A0606
10	6	20	65	RBA.A1006
12	6	25	70	RBA.A1206
16	6	25	70	RBA.A1606

# Type B

With end cut

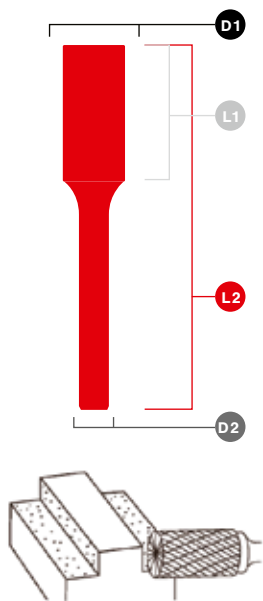

## Single cut

D1	D2	L1	L2	Code
3	3	13	38	RBS.B0303
6	6	16	61	RBS.B0606
8	6	20	65	RBS.B0806
10	6	20	65	RBS.B1006
12	6	25	70	RBS.B1206
16	6	25	70	RBS.B1606

## Double cut

D1	D2	L1	L2	Code
3	3	13	38	RB.B0303
6	6	16	61	RB.B0606
8	6	20	65	RB.B0806
10	6	20	65	RB.B1006
10	6	20	170	RBDL.B1006
12	6	25	70	RB.B1206
12	6	25	175	RBDL.B1206
16	6	25	70	RB.B1606

## Diamond cut

D1	D2	L1	L2	Code
8	6	20	65	RBD.B0806
10	6	20	65	RBD.B1006
12	6	25	70	RBD.B1206
16	6	25	70	RBD.B1606

## Alu cut

D1	D2	L1	L2	Code
6	6	16	61	RBA.B0606
10	6	20	65	RBA.B1006
12	6	25	70	RBA.B1206

# Type C

Ball nose cylinder

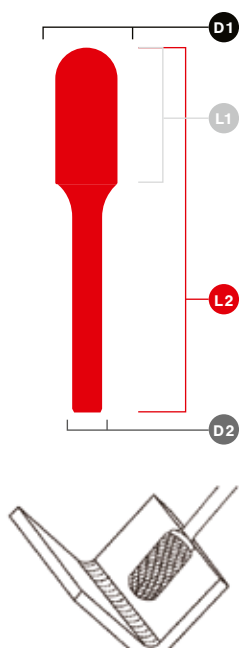

## Single cut

D1	D2	L1	L2	Code
3	3	13	38	RBS.C0303
6	6	16	61	RBS.C0606
8	6	20	65	RBS.C0806
9,5	6	20	65	RBS.C1006
12	6	25	70	RBS.C1206
16	6	25	70	RBS.C1606

## Double cut

D1	D2	L1	L2	Code
3	3	13	38	RB.C0303
6	6	16	61	RB.C0606
8	6	20	65	RB.C0806
10	6	20	65	RB.C1006
10	6	20	170	RBDL.C1006
12	6	25	70	RB.C1206
12	8	25	70	RB.C1208
12	6	25	175	RBDL.C1206
16	6	25	70	RB.C1606

## Diamond cut

D1	D2	L1	L2	Code
8	6	20	65	RBD.C0806
9,5	6	20	65	RBD.C1006
12	6	25	70	RBD.C1206
16	6	25	70	RBD.C1606

## Alu cut

D1	D2	L1	L2	Code
6	6	16	61	RBA.C0606
10	6	20	65	RBA.C1006
12	6	25	70	RBA.C1206
16	6	25	70	RBA.C1606

# CARBIDE ROTARY BURRS SPECIFICATIONS

## Type D

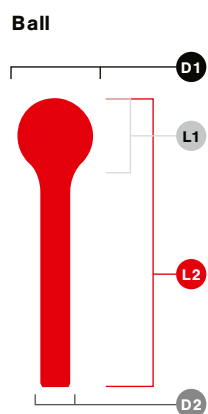

### Single cut

D1	D2	L1	L2	Code
3	3	2,7	38	RBS.D0303
6	6	5,4	50	RBS.D0606
8	6	7,2	52	RBS.D0806
10	6	9	54	RBS.D1006
12	6	10,8	55	RBS.D1206
16	6	14,4	59	RBS.D1606

### Double cut

D1	D2	L1	L2	Code
3	3	2,7	38	RB.D0303
6	6	5,4	50	RB.D0606
8	6	7,2	52	RB.D0806
10	6	9	54	RB.D1006
10	6	9	159	RBDL.D1006
12	6	10,8	55	RB.D1206
12	6	10,8	161	RBDL.D1206
16	6	14,4	59	RB.D1606

### Diamond cut

D1	D2	L1	L2	Code
8	6	7,2	52	RBD.D0806
10	6	9	54	RBD.D1006
12	6	10,8	55	RBD.D1206
16	6	14,4	59	RBD.D1606

### Alu cut

D1	D2	L1	L2	Code
6	6	5,4	50	RBA.D0606
10	6	9	54	RBA.D1006
12	6	10,8	55	RBA.D1206
16	6	14,4	59	RBA.D1606

## Type E

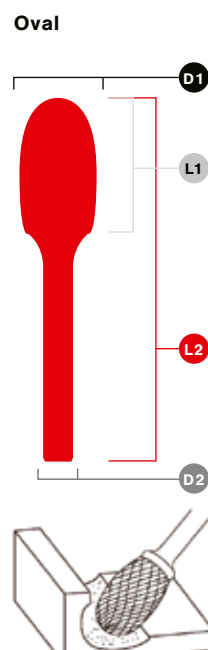

### Single cut

D1	D2	L1	L2	Code
3	3	7	38	RBS.E0303
6	6	10	55	RBS.E0606
8	6	13	58	RBS.E0806
10	6	16	61	RBS.E1006
12	6	20	65	RBS.E1206
16	6	25	75	RBS.E1606

### Double cut

D1	D2	L1	L2	Code
3	3	7	38	RB.E0303
6	6	10	55	RB.E0606
8	6	13	58	RB.E0806
10	6	16	61	RB.E1006
10	6	16	166	RBDL.E1006
12	6	20	65	RB.E1206
12	6	20	170	RBDL.E1206
16	6	25	70	RB.E1606

### Diamond cut

D1	D2	L1	L2	Code
8	6	13	58	RBD.E0806
10	6	16	61	RBD.E1006
12	6	20	65	RBD.E1206
16	6	25	70	RBD.E1606

### Alu cut

D1	D2	L1	L2	Code
6	6	10	55	RBA.E0606
10	6	16	61	RBA.E1006
12	6	20	65	RBA.E1206

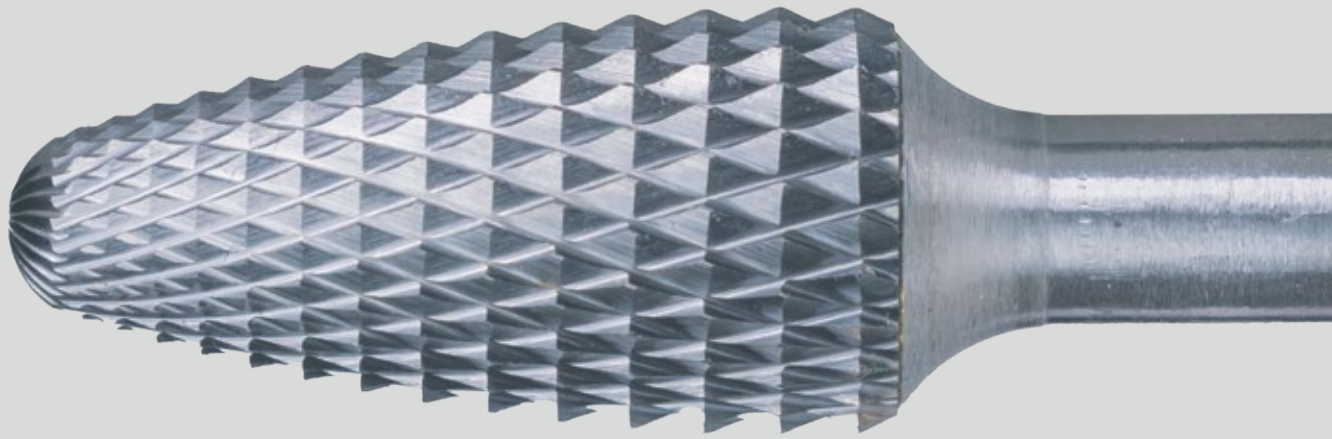

## Type F

Ball nose tree

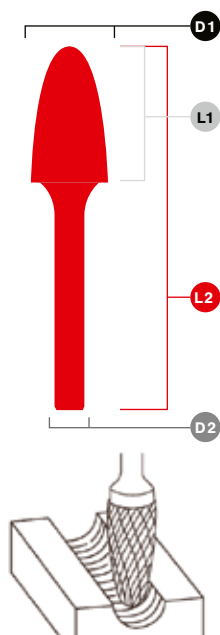

### Single cut

D1	D2	L1	L2	Code
3	3	13	38	RBS.F0303
6	6	18	63	RBS.F0606
8	6	20	65	RBS.F0806
10	6	20	65	RBS.F1006
12	6	25	70	RBS.F1206
16	6	25	70	RBS.F1606

### Double cut

D1	D2	L1	L2	Code
3	3	13	38	RB.F0303
6	6	18	63	RB.F0606
8	6	20	65	RB.F0806
10	6	20	65	RB.F1006
10	6	20	170	RBDL.F1006
12	6	25	70	RB.F1206
12	8	25	70	RB.F1208
12	6	25	175	RBDL.F1206
16	6	25	70	RB.F1606

### Diamond cut

D1	D2	L1	L2	Code
8	6	20	65	RBD.F0806
10	6	20	65	RBD.F1006
12	6	25	70	RBD.F1206
16	6	25	70	RBD.F1606

### Alu cut

D1	D2	L1	L2	Code
6	6	18	63	RBA.F0606
10	6	20	65	RBA.F1006
12	6	25	70	RBA.F1206
16	6	25	70	RBA.F1606

## Type G

Arc pointed tree

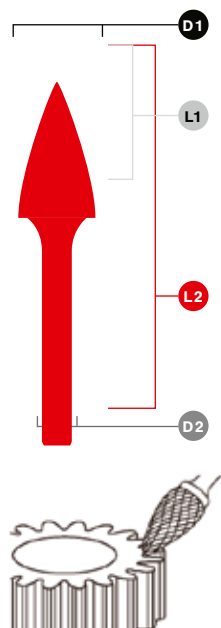

### Single cut

D1	D2	L1	L2	Code
3	3	13	38	RBS.G0303
6	6	18	63	RBS.G0606
8	6	20	65	RBS.G0806
10	6	20	65	RBS.G1006
12	6	25	70	RBS.G1206
16	6	25	70	RBS.G1606

### Double cut

D1	D2	L1	L2	Code
3	3	13	38	RB.G0303
6	6	18	63	RB.G0606
8	6	20	65	RB.G0806
10	6	20	65	RB.G1006
10	6	20	170	RBDL.G1006
12	6	25	70	RB.G1206
12	6	25	175	RBDL.G1206
16	6	25	70	RB.G1606

### Diamond cut

D1	D2	L1	L2	Code
8	6	20	65	RBD.G0806
9,5	6	20	65	RBD.G1006
12	6	25	70	RBD.G1206
16	6	25	70	RBD.G1606

### Alu cut

D1	D2	L1	L2	Code
6	6	18	63	RBA.G0606
10	6	20	65	RBA.G1006
12	6	25	70	RBA.G1206
16	6	25	70	RBA.G1606

# CARBIDE ROTARY BURRS SPECIFICATIONS

## Type H

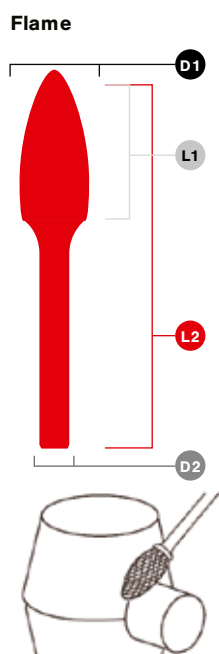

### Single cut

D1	D2	L1	L2	Code
3	3	13	38	RBS.H0303
6	6	18	63	RBS.H0606
8	6	20	65	RBS.H0806
10	6	20	65	RBS.H1006
12	6	25	70	RBS.H1206
16	6	36	81	RBS.H1606

### Double cut

D1	D2	L1	L2	Code
3	3	13	38	RB.H0303
6	6	18	63	RB.H0606
8	6	20	65	RB.H0806
10	6	25	70	RB.H1006
12	6	32	77	RB.H1206
12	6	32	202	RBDL.H1206
16	6	36	81	RB.H1606

### Diamond cut

D1	D2	L1	L2	Code
8	6	20	65	RBD.H0806
10	6	25	70	RBD.H1006
12	6	32	77	RBD.H1206
16	6	36	81	RBD.H1606

### Alu cut

D1	D2	L1	L2	Code
6	6	18	63	RBA.H0606
10	6	25	70	RBA.H1006
12	6	32	77	RBA.H1206
16	6	36	81	RBA.H1606

## Type J

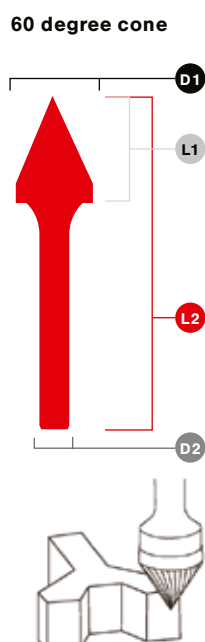

### Single cut

D1	D2	L1	L2	Code
6	6	5,2	50	RBS.J0606
10	6	8,7	53	RBS.J1006
12	6	10,4	55	RBS.J1206
16	6	13,8	58	RBS.J1606

### Double cut

D1	D2	L1	L2	Code
6	6	5,2	50	RB.J0606
10	6	8,7	53	RB.J1006
12	6	10,4	55	RB.J1206
16	6	13,8	58	RB.J1606

### Diamond cut

D1	D2	L1	L2	Code
10	6	8,7	57	RBD.J1006
12	6	10,4	60	RBD.J1206
16	6	13,8	63	RBD.J1606

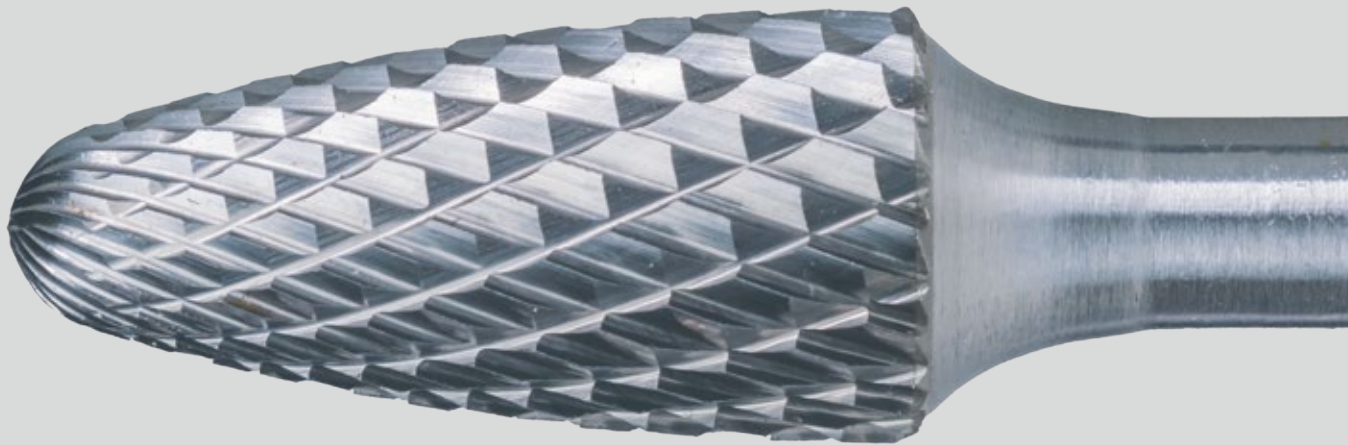

## Type K

90 degree cone

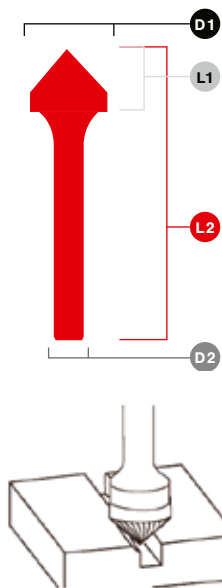

### Single cut

D1	D2	L1	L2	Code
6	6	3	48	RBS.K0606
10	6	5	50	RBS.K1006
12	6	6	51	RBS.K1206
16	6	8	53	RBS.K1606

### Double cut

D1	D2	L1	L2	Code
6	6	3	48	RB.K0606
10	6	5	50	RB.K1006
12	6	6	51	RB.K1206
16	6	8	53	RB.K1606

### Diamond cut

D1	D2	L1	L2	Code
10	6	5	55	RBD.K1006
12	6	6,5	55	RBD.K1206
16	6	8,5	59	RBD.K1606

## Type L

Ball nose cone

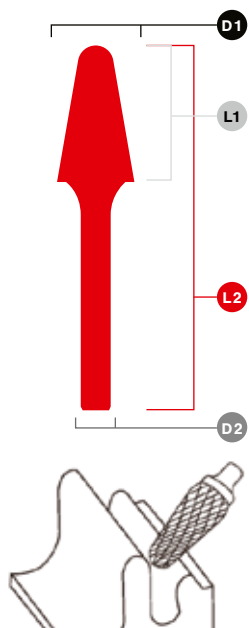

### Single cut

D1	D2	L1	L2	Code
3	3	13	38	RBS.L0303
6	6	16	61	RBS.L0606
8	6	22	67	RBS.L0806
10	6	25	70	RBS.L1006
12	6	28	73	RBS.L1206
16	6	33	78	RBS.L1606

### Double cut

D1	D2	L1	L2	Code
3	3	13	38	RB.L0303
6	6	18	61	RB.L0606
8	6	22	67	RB.L0806
10	6	25	70	RB.L1006
10	6	25	175	RBDL.L1006
12	6	28	73	RB.L1206
12	6	28	178	RBDL.L1206
16	6	33	78	RB.L1606

### Diamond cut

D1	D2	L1	L2	Code
8	6	22	67	RBD.L0806
10	6	25	70	RBD.L1006
12	6	28	73	RBD.L1206
16	6	33	78	RBD.L1606

### Alu cut

D1	D2	L1	L2	Code
6	6	18	61	RBA.L0606
10	6	25	70	RBA.L1006
12	6	28	73	RBA.L1206

# CARBIDE ROTARY BURRS SPECIFICATIONS

## Type M

Cone

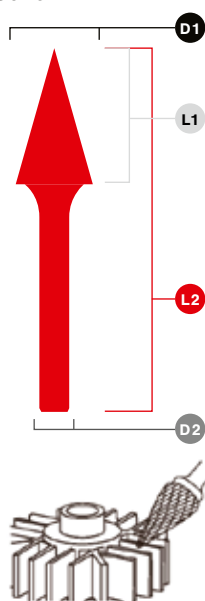

### Single cut

D1	D2	L1	L2	Code
3	3	11	38	RBS.M0303
6	6	18	63	RBS.M0606
8	6	20	65	RBS.M0806
10	6	20	65	RBS.M1006
12	6	25	70	RBS.M1206
16	6	25	70	RBS.M1606

### Double cut

D1	D2	L1	L2	Code
3	3	11	38	RB.M0303
6	6	18	63	RB.M0606
8	6	20	65	RB.M0806
10	6	20	65	RB.M1006
12	6	25	70	RB.M1206
16	6	25	70	RB.M1606

### Diamond cut

D1	D2	L1	L2	Code
8	6	20	65	RBD.M0806
10	6	20	65	RBD.M1006
12	6	25	70	RBD.M1206
16	6	25	70	RBD.M1606

### Alu cut

D1	D2	L1	L2	Code
6	6	18	63	RBA.M0606
10	6	20	65	RBA.M1006
12	6	25	70	RBA.M1206

## Type N

Inverted cone

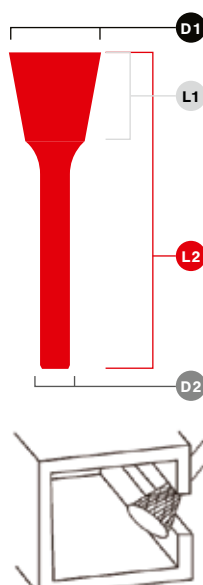

### Single cut

D1	D2	L1	L2	Code
3	3	4	38	RBS.N0303
6	6	7	52	RBS.N0606
10	6	10	55	RBS.N1006
12	6	13	58	RBS.N1206
16	6	16	61	RBS.N1606

### Double cut

D1	D2	L1	L2	Code
3	3	4	38	RB.N0303
6	6	7	52	RB.N0606
10	6	10	55	RB.N1006
12	6	13	58	RB.N1206
16	6	16	61	RB.N1606

### Diamond cut

D1	D2	L1	L2	Code
10	6	10	55	RBD.N1006
12	6	13	58	RBD.N1206
16	6	16	61	RBD.N1606

# CARBIDE ROTARY BURRS SETS



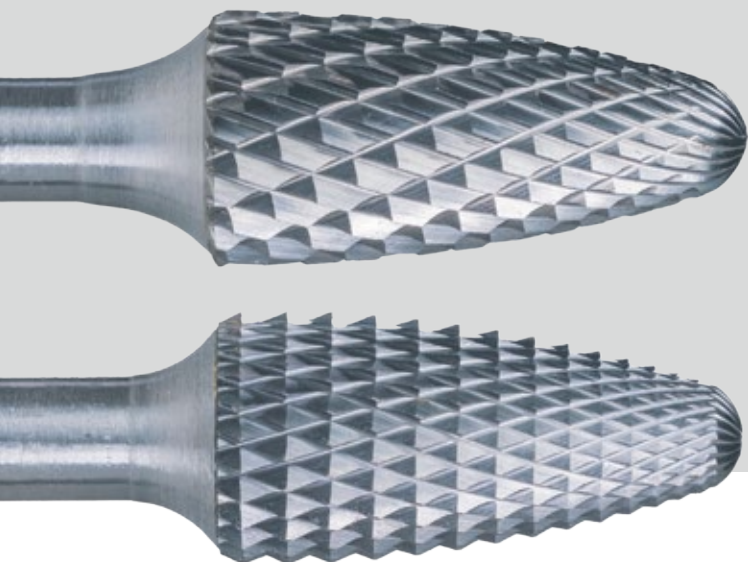

# CARBIDE ROTARY BURR SETS

The most commonly used carbide burr shapes and dimensions are now available in sets of 5 and 10 pcs.

These very handy sets come in small boxes that protect the burrs from damage and dirt.

Thanks to the small size, the boxes fit perfectly in your tool case.

The burrs are secured at the shank, preventing it from falling out while transported.



**Double cut**  
Set 5 pcs (RBS.0510)

D1	D2	L1	L2	Model
10	6	20	65	RB.B1006
10	6	20	65	RB.C1006
10	6	20	65	RB.F1006
10	6	20	65	RB.G1006
10	6	25	70	RB.L1006



**Double cut**  
Set 5 pcs (RBS.0512)

D1	D2	L1	L2	Model
12	6	25	70	RB.B1206
12	6	25	70	RB.C1206
12	6	25	70	RB.F1206
12	6	25	70	RB.G1206
12	6	28	73	RB.L1206



**Diamond cut**  
Set 5 pcs (RBS.0510D)

D1	D2	L1	L2	Model
10	6	20	65	RBD.B1006
10	6	20	65	RBD.C1006
10	6	20	65	RBD.F1006
9,5	6	20	65	RBD.G1006
10	6	25	70	RBD.L1006



**Diamond cut**  
Set 5 pcs (RBS.0512D)

D1	D2	L1	L2	Model
12	6	25	70	RBD.B1206
12	6	25	70	RBD.C1206
12	6	25	70	RBD.F1206
12	6	25	70	RBD.G1206
12	6	28	73	RBD.L1206



# CARBIDE ROTARY BURR SETS



## Double cut

Set 10 pcs (RBS.1010)

D1	D2	L1	L2	Model	QTY
10	6	20	65	RB.B1006	2
10	6	20	65	RB.C1006	2
10	6	20	65	RB.F1006	2
10	6	20	65	RB.G1006	2
10	6	25	70	RB.L1006	2



## Diamond cut

Set 10 pcs (RBS.1010D)

D1	D2	L1	L2	Model	QTY
10	6	20	65	RBD.B1006	2
10	6	20	65	RBD.C1006	2
10	6	20	65	RBD.F1006	2
10	6	20	65	RBD.G1006	2
10	6	25	70	RBD.L1006	2



## Double cut

Set 10 pcs (RBS.1012)

D1	D2	L1	L2	Model	QTY
12	6	25	70	RB.B1206	2
12	6	25	70	RB.C1206	2
12	6	25	70	RB.F1206	2
12	6	25	70	RB.G1206	2
12	6	28	73	RB.L1206	2



## Diamond cut

Set 10 pcs (RBS.1012D)

D1	D2	L1	L2	Model	QTY
12	6	25	70	RBD.B1206	2
12	6	25	70	RBD.C1206	2
12	6	25	70	RBD.F1206	2
12	6	25	70	RBD.G1206	2
12	6	28	73	RBD.L1206	2



## Double cut

Set 10 pcs (RBS.BOX)

D1	D2	L1	L2	Model
6	6	13	61	RB.B0606
6	6	16	61	RB.C0606
6	6	5,4	50	RB.D0606
6	6	18	63	RB.F0606
6	6	18	63	RB.G0606

D1	D2	L1	L2	Model
12	6	25	70	RB.B1206
12	6	25	70	RB.C1206
12	6	10,8	55	RB.D1206
12	6	25	70	RB.F1206
12	6	25	70	RB.G1206



# DIE GRINDING MACHINES

The Euroboor grinding machines are developed with a focus on minimizing vibrations and being easy and safe in operation. The purpose of all Euroboor grinding machines is realizing smooth, high quality finishes while taking the minimum of your time and energy.

Euroboor has both electric and air pressured grinding machines which offer you great results under all circumstances.



**ADG.2A**

Air pressured lightweight  
grinding machine (90° angle)



**ADG.2S**

Air pressured lightweight  
grinding machine (straight)



**ADG.2E**

Air pressured lightweight  
grinding machine (extended shaft)



**EDG.600**

Electric grinding machine



**EBG.600/18V**

Battery operated grinding machine



***VibraTec***  
Technology

**Minimize Vibrations!**

- Better & easier operation!
- Smooth & high quality finish!
- Reduces strain and fatigue

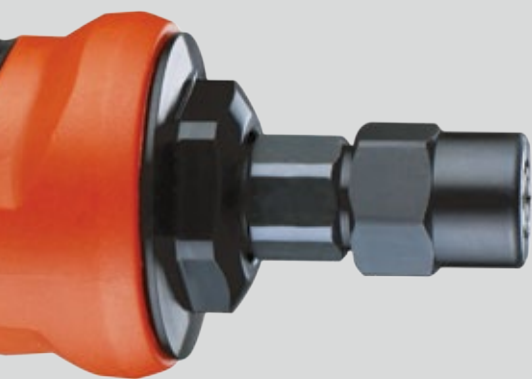

# ADG.2S

## AIR DIE GRINDER STRAIGHT





## Air Die Grinder Straight

The Euroboor ADG.2S pneumatic grinder is your number one choice for grinding, polishing, deburring and smoothening sharp edges. The ADG.2S is compact, lightweight and fast! The Euroboor air die grinders offer maximum safety and comfort because of its soft grip, with rubber pads and a non-slip trigger with safety lever.

This ergonomic grip also contributes to minimizing Vibrations for greater finishes!

A four-speed air regulator provides an extra ease of operation and contributes to perfect finishes on all sorts of materials, while a 360° rotatable air exhaust provides an extra edge of comfort to the machine.

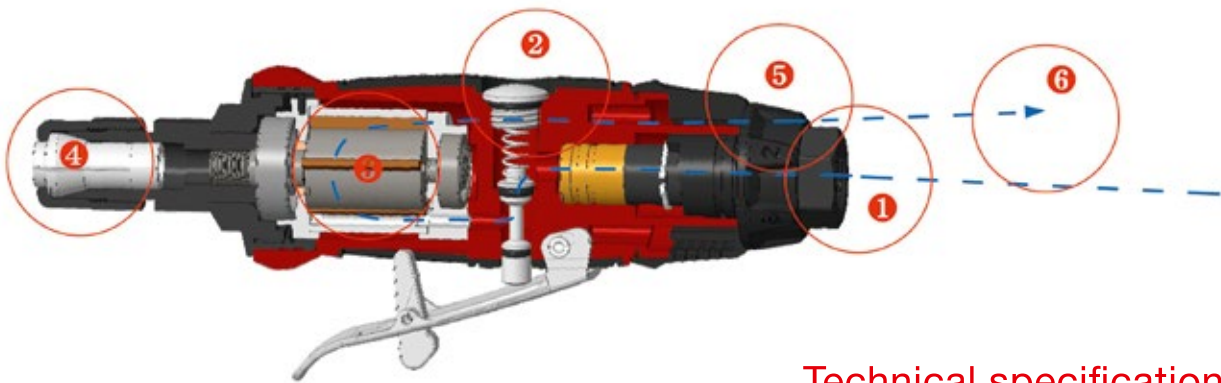

- 1 - Built-in air filter protect motor from dirt
- 2 - Soft grip with non-slip trigger and rubber pads for maximum grip
- 3 - Heavy duty motor, air powered
- 4 - Collet, made of hardened steel
- 5 - 4-speed air regulator
- 6 - 360° adjustable air exhaust

## Technical specifications

Standard collet	6 mm
Max. RPM (no load)	20,000 rpm
Speed 1	9,500 rpm
Speed 2	13,000 rpm
Speed 3	18,000 rpm
Speed 4	20,000 rpm
Average air consumption	142 l/m (5 SCFM)
Working air pressure	6.3 bar (90 PSI)
Air hose size	3/8"
Air inlet size	1/4"
Weight	0.67 kg
Length	193 mm
Height	70 mm

### Machine includes:

- 1x Machine ADG.2S
- 1x Collet 6 mm (1/4")
- 3x Air nipple (1/4")
- 2x wrench



### Part numbers:

Machine: ADG.2S

Also available in case: ADG.2S-CASE

Also available as set: ADG.2S-SET

# Air Die Grinder Angle

The Euroboor ADG.2A pneumatic grinder is the perfect choice for small and difficult to reach spaces. Suitable for grinding, polishing, deburring and smoothing sharp edges.

The Euroboor Air die grinders offer maximum safety and comfort because of its soft grip, with rubber pads and a non-slip trigger

with safety lever. This ergonomic grip also contributes to minimizing vibrations for greater finishes! The 90° angle makes this machine perfectly suitable for working from above, below or in tight spaces.

With the powerful air pressured engine, this machine will do the job!





# ADG.2A

## AIR DIE GRINDER

### ANGLE

#### Technical specifications

Standard collet	6 mm
Max. RPM (no load)	20,000 rpm
Speed 1	10,000 rpm
Speed 2	17,000 rpm
Speed 3	19,000 rpm
Speed 4	20,000 rpm
Average air consumption	113 l/m (4 SCFM)
Working air pressure	6.3 bar (90 PSI)
Air hose size	3/8"
Air inlet size	1/4"
Weight	0.53 kg
Length	193 mm
Height	70 mm

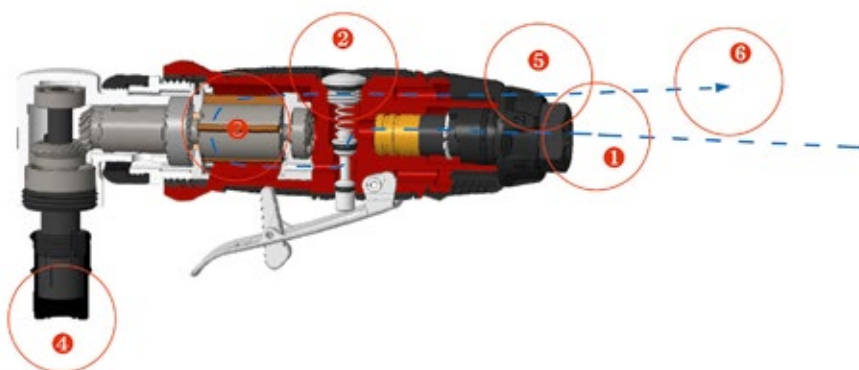

- 1 - Built-in air filter protect motor from dirt
- 2 - Soft grip with non-slip trigger and rubber pads for maximum grip
- 3 - Heavy duty motor, air powered
- 4 - Collet, made of hardened steel
- 5 - 4-speed air regulator
- 6 - 360° adjustable air exhaust

#### Machine includes:

- 1x Machine ADG.2A
- 1x Collet 6 mm (1/4")
- 3x Air nipple (1/4")
- 2x wrench



#### Part numbers:

- Machine: ADG.2A
- Also available in case: ADG.2A-CASE
- Also available as set: ADG.2A-SET



# ADG.2E

## AIR DIE GRINDER EXTENDED

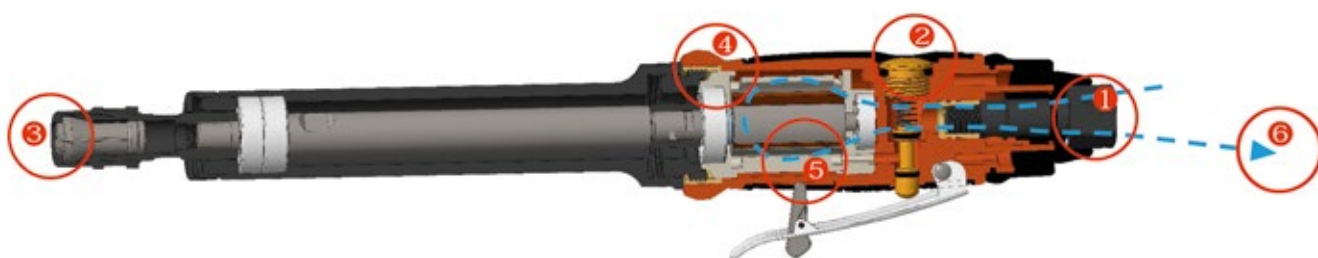

- 1 - Built-in air filter protect motor from dirt
- 2 - Soft grip with non-slip trigger and rubber pads for maximum grip
- 3 - Heavy duty motor, air powered
- 4 - Collet, made of hardened steel
- 5 - 4-speed air regulator perfect finishes
- 6 - 360° air exhaust for extra comfort

### Technical specifications

Standard collet	6 mm
Max. RPM (no load)	22000 rpm
Speed 1	9,000 rpm
Speed 2	14,000 rpm
Speed 3	18,000 rpm
Speed 4	22,000 rpm
Average air consumption	142 l/m (5 SCFM)
Working air pressure	6.3 bar (90 PSI)
Air hose size	3/8"
Air inlet size	1/4"
Weight	1.31 KG
Length	338 mm
Height	70 mm



### Machine includes:

- 1x Machine ADG.2E
- 1x Collet 6 mm (1/4")
- 3x Air nipple (1/4")
- 2x wrench



### Part numbers:

- Machine: ADG.2E
- Also available in case: ADG.2E-Case
- Also available as set: ADG.2E-SET

## Air Die Grinder Extended

The Euroboor ADG.2E pneumatic grinder with 150mm shaft is the perfect machine for working just out of reach! Suitable for grinding, polishing, deburring and smoothening sharp edges.

The Euroboor Air die grinders offer maximum safety and comfort because of its soft grip, with rubber pads and a non-slip trigger

with safety lever. The Vibratex technology contributes to minimizing vibrations for greater finishes! A four-speed air regulator provides an extra ease of operation and contributes to perfect finishes on all sorts of materials, while a 360° rotatable air exhaust provides an extra edge of comfort to the machine.





# EDG.600 ELECTRIC DIE GRINDER





## Electric Die Grinder

No air? No problem! Electric grinder EDG.600 is your partner for all types of grinding work. It has an ergonomic shape and is versatile. An auxiliary handle provides extra grip and precision!

heavy load. The EDG.600 is also equipped with a 6-speed preselector for use on different materials. The ergonomic grip and high quality bearings deliver less vibration, thus better work quality!

The powerful 600-watt motor gives a soft start. The EDG.600 delivers a constant speed, also under

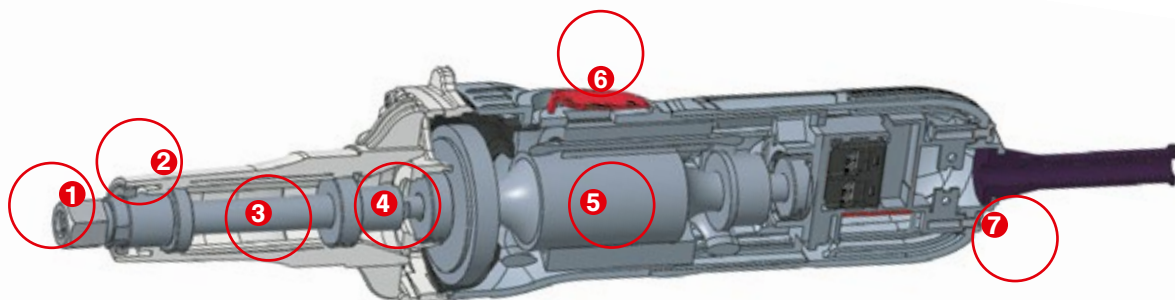

- 1 - Nut/M15
- 2 - Dustproof cover
- 3 - Spindle
- 4 - Adaptor
- 5 - Motor
- 6 - Switch
- 7 - Adjustable speed regulator

## Technical specifications

Standard collet	6 mm
RPM	12000 - 27000
Motor power	600 W (5A)
Voltage	220-240V / 50-60 HZ
Weight	1.8 KG
Length	350 mm
Height	80 mm

### Machine

- 1x Machine EDG.600
- 1x Collet 6 mm (1/4")
- 2x Wrench
- 2x Carbon Brush
- 1x Handle



### Part numbers:

- Machine: EDG.600
- Also available in case: EDG.600 CASE
- Also available as set: EDG.600 SET

# Battery Operated Die Grinder

The EBG.600/18V die grinder, powered by an 18V battery for cordless convenience and mobility. Featuring a powerful 800W brushless motor and a stepless adjustable speed range.

Compatible with 6 mm or 1/4" shanks, covering Euroboor's full range of rotary burrs. The grinder

offers smooth performance with a rotation speed stabilization system, ensuring consistency even under load. Its ergonomic design provides an excellent grip and balance. The Makita 18V LXT battery platform allows you to use the same battery across multiple tools.

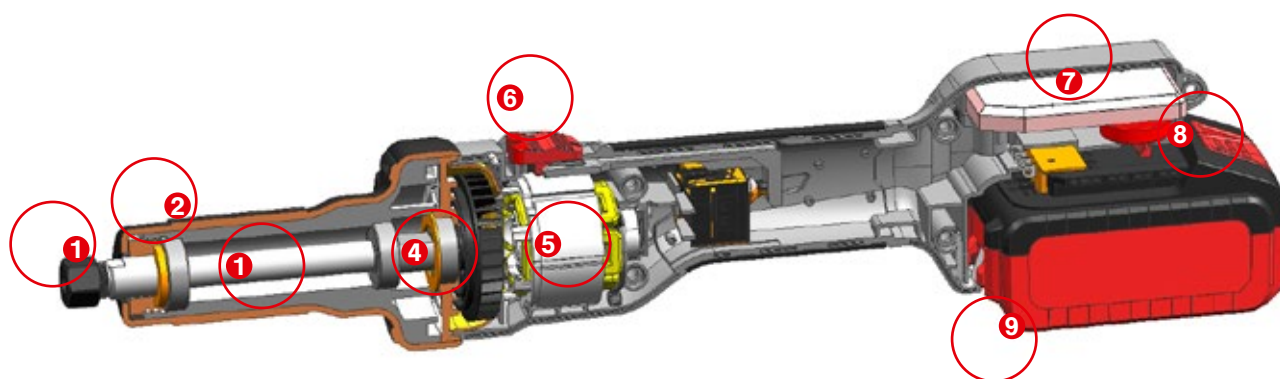

- 1 - Nut/M15
- 2 - Dustproof cover
- 3 - Spindle
- 4 - Adaptor
- 5 - Motor
- 6 - Switch
- 7 - Control board
- 8 - Stepless adjustable speed regulator
- 9 - Battery

## Technical specifications

Standard collet	6 mm
RPM	7000 - 26000
Motor power	800 W
Battery capacity	18 V 5Ah or 18 V 9Ah
Weight	1,5 kg
Lenght	450 mm
Height	83 mm



### Machine

- 1x Machine EBG.600/18V
- 1x Collet 6 mm (1/4")
- 2x Wrench

### Part numbers:

- Machine: EBG.600/18V
- Also available as set:
- EBG.600/18V Set (5Ah),
- EBG.600/18V Set (9Ah)



# EBG.600/18V

## BATTERY OPERATED ELECTRIC DIE GRINDER



# CARBIDE BURRS AND MACHINE GUIDELINES

Before purchasing and/or using rotary burrs Euroboor advises to walk through the steps below. Purchasing the right rotary burr for each situation and application results in:

- Lower Energy Costs
- Better results
- Long lasting quality
- Safer working environment

	Cast iron	Cast steel	Unhardened steels	Hardened steels	Low alloy steels	High alloy steels	Heat treated steels	Stainless steel	Titanium alloy	Brass	Bronze / Copper	Plastics	Aluminium	Zinc alloy
Single cut	•	•	•		•			•		•	•			
Double cut	•	•	•		•			•		•	•			
Diamond cut	•	•	•	•	•	•	•	•	•	•	•			
Alu cut												•	•	•

**1** Please consider the materials you will use the burr on and select the correct cut.

**2** Choose the right cut and consider the result you want. Choose the model that can do the job (model A – N)

**3** Choose the shank diameter (D2) that fits your grinding machine's collet.

**4** Choose your burr diameter (D1) for the result that you want. For the best result see the recommended RPM's of each burr, specified per material in the table on the next page.

**5** After choosing the correct burr diameter (D1), refer to the table on the following page for the machine speed that is recommended for the best possible result, specified per material. Please keep in mind all safety advice and warnings.



## Operating:

- Avoid excessive pressure to maintain optimal grinding speed and prevent damage.
- Maximize contact with the workpiece for a smoother finish.
- Prevent contact between the shank and the workpiece to avoid tool wear.
- Replace dull burrs before they become too worn to ensure efficiency.
- Periodically dip the burr in wax to improve performance and extend its lifespan.
- Regularly check air pressure, fittings, and seals to maintain optimal RPM and power.
- Use the correct speed for the material to achieve the best finish and removal rate, refer to the speed chart for guidance.

## Recommended rotational speed

When choosing the right rotational speed (RPM), please consider the following:

### 1. The material 2. The burr diameter

## Speed recommendation chart

Below table lists recommended rotational speeds (RPM x1,000) based on burr diameter and material type.

Material	3 mm	6 mm	8 mm	10 mm	12 mm	16 mm	20 mm	25 mm
Stainless Steel	30 - 50	15 - 25	12 - 20	10 - 15	9 - 12	7 - 10	5 - 7	4 - 5
Steel	60 - 90	30 - 45	25 - 35	20 - 30	15 - 25	10 - 18	10 - 14	8 - 10
Hardened / Tool Steel	30 - 40	15 - 20	10 - 15	10 - 15	8 - 10	5 - 8	4 - 7	3 - 5
Cast Iron	60 - 90	30 - 45	25 - 35	20 - 30	15 - 20	10 - 18	10 - 14	8 - 10
Aluminium / Plastics	30 - 90	15 - 60	12 - 50	10 - 50	8 - 35	6 - 30	5 - 20	4 - 15
Copper	30 - 90	15 - 60	12 - 50	10 - 50	8 - 35	6 - 30	5 - 20	4 - 15
Brass	40 - 50	20 - 30	15 - 20	13 - 17	10 - 15	8 - 12	6 - 8	5 - 6
Zinc	60 - 90	30 - 45	25 - 35	20 - 30	15 - 25	10 - 18	10 - 14	8 - 10
Nickel / Titanium	30 - 40	15 - 20	10 - 15	10 - 15	8 - 10	5 - 8	4 - 7	3 - 5

## Troubleshooting:

Occurance	Solution
Clogged burr	Use the correct burr for the materials
Heavy discoloration between shank and toothed section	Adjust RPM and/or reduce the pressure and/or adjust angle
The head breaks off	Adjust RPM and/or reduce the pressure and/or adjust angle
Sparks	Reduce RPM or ensure no more than 1/3rd of burr's surface touches working area
Heavy splintering or chipping of burr	Reduce stress on working area
Shank breach	Use rigid power tools or replace clamping system of power tool
Strong vibrations or sudden heavy sparks	Replace the burr as the lifetime has passed

## Safety:

- Use only rigid clamping systems and/or power tools to prevent premature tear.
- Do not engage more than 1/3 of the burr's surface with the material to avoid rough milling, which can damage the burr's teeth.
- Start cutting against the rotation, then finish with the rotation for a smooth surface.
- Use powerful machines with a smooth grip to reduce vibration and improve control.



Wear a mask



Wear ear protection



Wear safety glasses



Wear gloves

# **EUROBOOR**

FOR PROFESSIONALS BY PROFESSIONALS

## **TOOLS FOR METAL PROFESSIONALS**

### **www.euroboor.com**

Drilling - Bevelling - Sawing - Grinding - Lifting

#### **The Netherlands office**

Kryptonstraat 110  
2718 TD Zoetermeer  
t +31(0)79 361 49 90  
e info.nl@euroboor.com

#### **Brasil office**

Rua Harpia 438 Novo Horizonte,  
Serra, 29.163-308  
Espírito Santo, Brasil  
t +55 27 98827 1043  
e contato.br@euroboor.com

#### **UAE office**

SAIF Zone A2-084  
P.O. Box No: 120085, Sharjah  
t +971 655 784 54  
e info.uae@euroboor.com

#### **USA office**

160 White Oak Road  
Hayden, AL 35079  
t +1 844 266 85 27  
e info.usa@euroboor.com



Euroboor makes every effort to meet quality and integrity requirements. That is why we as an organization are proud of the recognition of some leading organizations worldwide.

\*Disclaimer: Euroboor is not liable for any damage caused to the machine due to electrical problems in the workplace. Above mentioned protection is not guaranteed in all cases of voltage spikes and/or frequency fluctuations. Euroboor accepts no liability when it comes to the power protection not functioning or functioning poorly